

**OWATONNA, MINNESOTA**  
**STEELE COUNTY T107N R20W**  
**OFFICE OF CITY ENGINEER**  
**ZONING MAP OF OWATONNA**  
**ORDINANCE NO.827**  
**ADOPTED BY CITY COUNCIL**  
**APRIL 19, 1983**  
**REVISED JULY 2008**  
**9,021.49 ACRES**  
**14.09 SQ. MILES**

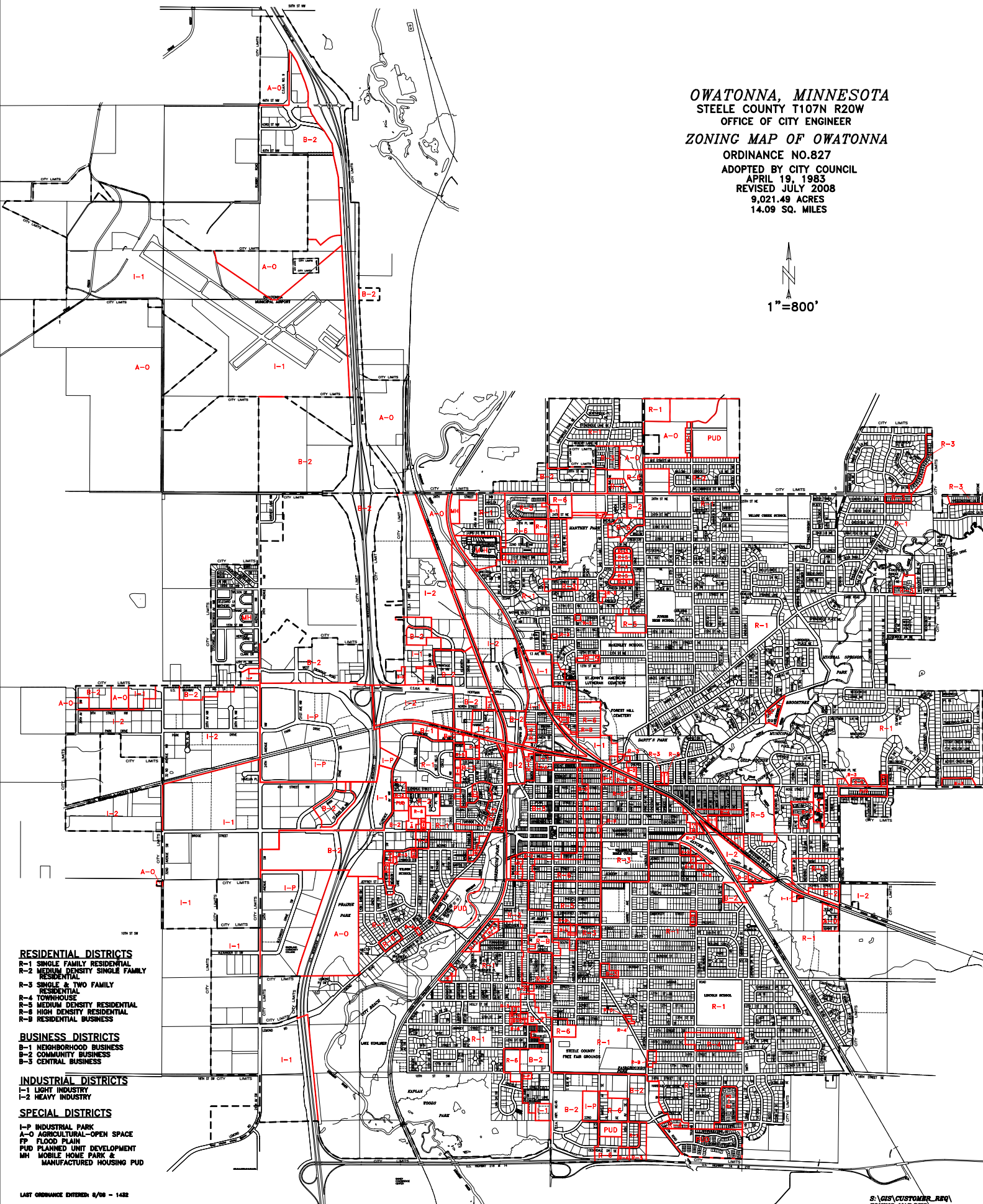
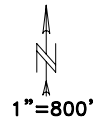

- RESIDENTIAL DISTRICTS**  
R-1 SINGLE FAMILY RESIDENTIAL  
R-2 MEDIUM DENSITY SINGLE FAMILY RESIDENTIAL  
R-3 SINGLE & TWO FAMILY RESIDENTIAL  
R-4 TOWNHOUSE  
R-5 MEDIUM DENSITY RESIDENTIAL  
R-6 HIGH DENSITY RESIDENTIAL  
R-9 RESIDENTIAL BUSINESS
- BUSINESS DISTRICTS**  
B-1 NEIGHBORHOOD BUSINESS  
B-2 COMMUNITY BUSINESS  
B-3 CENTRAL BUSINESS
- INDUSTRIAL DISTRICTS**  
I-1 LIGHT INDUSTRY  
I-2 HEAVY INDUSTRY
- SPECIAL DISTRICTS**  
I-P INDUSTRIAL PARK  
A-O AGRICULTURAL-OPEN SPACE  
FP FLOOD PLAIN  
PUD PLANNED UNIT DEVELOPMENT  
MH MOBILE HOME PARK & MANUFACTURED HOUSING PUD